

Throttle Body

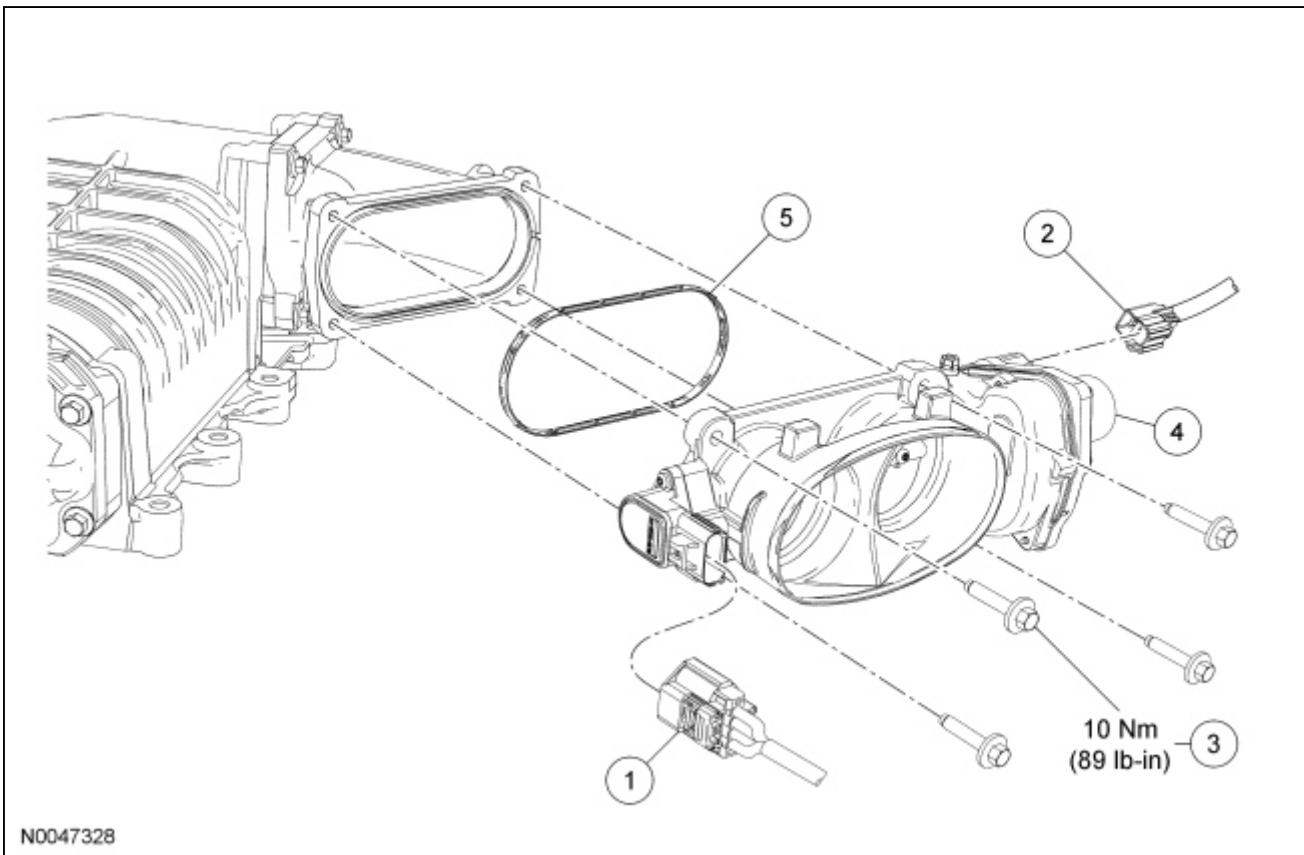

Item	Part Number	Description
1	14A464	Throttle Position (TP) sensor electrical connector (part of 12B637)
2	14A464	Electronic throttle control electrical connector (part of 12B637)
3	N806154	Throttle Body (TB) bolt (4 required)
4	9F991	TB
5	9E936	TB -to- TB spacer gasket

Removal and Installation

1. Remove the Air Cleaner (ACL) outlet pipe. For additional information, refer to [Section 303-12](#).
2. Disconnect the Throttle Position (TP) sensor electrical connector.
3. Disconnect the electronic throttle control electrical connector.
4. Remove the 4 bolts and the Throttle Body (TB) and discard the gasket.
 - To install, tighten to 10 Nm (89 lb-in).
5. To install, reverse the removal procedure.
 - Install a new [TB](#) gasket.

